

CITY OF PLEASANTON

PUBLIC WORKS DEPARTMENT

2026 MISCELLANEOUS SIDEWALK AND PATHWAY REPLACEMENT PROJECT - CIP NO. 26511

BID SET, APRIL 2026

LOCATION MAP

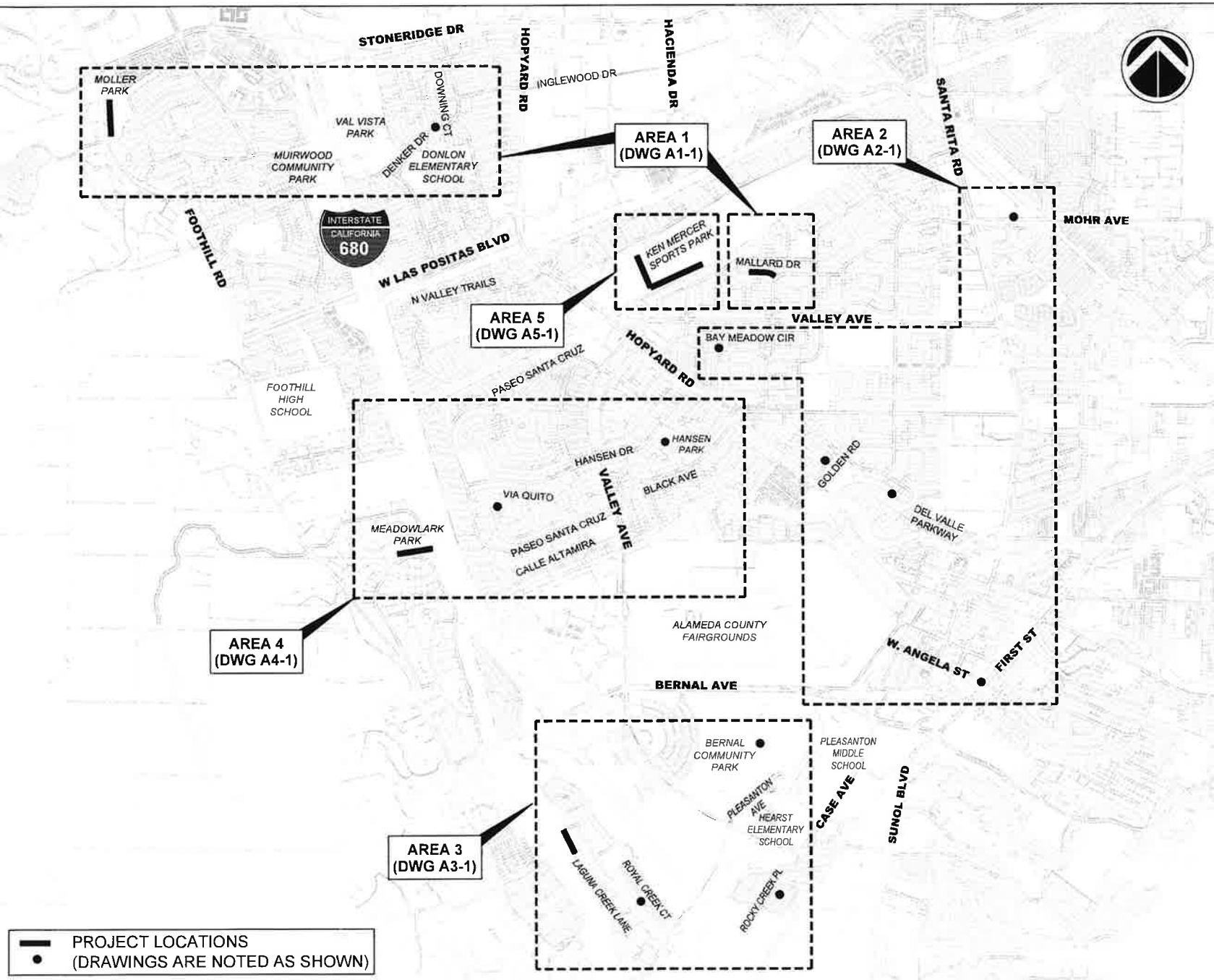

SHEET INDEX

SHEET NO.	DRAWING NO.	DESCRIPTION
1	G-1	TITLE SHEET
2	G-2	GENERAL NOTES
3	G-3	POLLUTION PREVENTION PLAN
4	A1-1	DOWNING COURT, MALLARD DRIVE AND MOLLER PARK
5	A2-1	BAY MEADOW CIRCLE, GOLDEN ROAD, MOHR AVENUE, DEL VALLEY PARKWAY, FIRST STREET AND W. ANGELA STREET
6	A3-1	BERNAL COMMUNITY PARK, LAGUNA CREEK LANE, ROCKY CREEK PLACE, AND ROYAL COURT
7	A4-1	HANSEN PARK, MEADOWLARK PARK, AND VIA QUITO
8	A5-1	KEN MERCER SPORTS PARK

ABBREVIATIONS

AB	AGGREGATE BASE	DET	DETAIL	LOG	LIP OF GUTTER	ST	STREET
AC	ASPHALT CONCRETE	DI	DRAIN INLET	LF	LINEAR FEET	STD	STANDARD
AVE	AVENUE	DR	DRIVE	LS	LANDSCAPE	S/W	SIDEWALK
BOC	BACK OF CURB	D/W	DRIVEWAY	MAX	MAXIMUM	TOC	TOP OF CURB
BL/BLVD	BOULEVARD	EA	EACH	MIN	MINIMUM	TS	TRAFFIC SIGNAL
BM	BENCH MARK	EP	EDGE OF PAVEMENT	MH	MAN HOLE	TYP	TYPICAL
BSW	BACK OF SIDEWALK	EX	EXISTING	NTS	NOT TO SCALE	VG	VALLEY GUTTER
CP	CONTROL POINT	FOC	FACE OF CURB	OS	OVERSIZED	WM	WATER METER
C/G	CURB AND GUTTER	FH	FIRE HYDRANT	PAV	PAVEMENT	WV	WATER VALVE
CIR	CIRCLE	FL	FLOW LINE	R	RADIUS	W/	WITH
CT	COURT	FT	FEET	RD	ROAD	"	INCH
C/L	CENTERLINE	GB	GRADE BREAK	R/W	RIGHT-OF-WAY	'	FEET
DWG	DRAWING	HMA	HOT MIX ASPHALT	R/R	REMOVE AND REPLACE	@	AT
		SF	SQUARE FEET				

LEGEND

	RIGHT OF WAY
	EX. DRAIN INLET
	EX. TREE



Michael A. Stella
MICHAEL A. STELLA, CITY ENGINEER

REV.	DATE	DESCRIPTION		CITY OF PLEASANTON PUBLIC WORKS DEPARTMENT		MICHAEL A. STELLA CITY ENGINEER NO. 54642	2026 MISCELLANEOUS SIDEWALK AND PATHWAY REPLACEMENT TITLE SHEET	DESIGN: BC DRAWN: SN CHECKED: BC TRAFFIC ENGINEER: MT	SCALE: AS SHOWN PROJECT NO.: CIP-26511 DATE: APRIL 20, 2026	DRAWING NO. G-1 1 OF 8
------	------	-------------	--	--	--	---	---	--	---	-------------------------------------

I:\deluch\pww\Engineering\Streets\Miscellaneous Sidewalk and Pathway Replacement\CIP-26511\Drawings\CAD\CIP-26511_GENERAL.dwg/4-24-26 11:46am snguyen

GENERAL NOTES

1. ALL MATERIAL AND WORKMANSHIP SHALL FULLY CONFORM WITH THE SPECIFICATIONS, STANDARDS AND ORDINANCES OF THE CITY OF PLEASANTON. STANDARD SPECIFICATIONS AND DETAILS ARE AVAILABLE AT THE PUBLIC WORKS DEPARTMENT.
2. THE OFFICE OF PUBLIC WORKS INSPECTION (925-931-5690) SHALL BE NOTIFIED 24 HOURS PRIOR TO THE START OF ANY WORK BY THE CONTRACTOR OR SUBCONTRACTORS.
3. IT SHALL BE THE CONTRACTOR'S RESPONSIBILITY TO DETERMINE THE EXISTENCE AND LOCATION OF ALL UNDERGROUND UTILITIES. THE CONTRACTOR SHALL NOTIFY UTILITY COMPANIES 48 HOURS PRIOR TO CONSTRUCTION TO FIELD LOCATE UTILITIES. CONTACT UNDERGROUND SERVICE ALERT AT 800-642-2444. ANY ADDED COST ON THE PART OF THE CONTRACTOR AS A RESULT OF THE ACTUAL LOCATION OF EXISTING UTILITIES BEING DIFFERENT FROM THOSE SHOWN ON THE PLANS SHALL BE BORNE BY THE CONTRACTOR AND ASSUMED INCLUDED IN THE CONTRACT UNIT PRICE.
4. THE CONTRACTOR SHALL BE HELD RESPONSIBLE FOR ANY FIELD CHANGES MADE WITHOUT WRITTEN AUTHORIZATION FROM THE CITY INSPECTOR.
5. CURB AND GUTTER PAY ITEM WILL BE BASED ON HORIZONTAL MEASUREMENTS.
6. CONTRACTOR SHALL PROVIDE TRAFFIC AND PEDESTRIAN CONTROL INCLUDING FLAG PERSONS PER SPECIFICATIONS AND SHALL SUBMIT A TRAFFIC CONTROL PLAN SUBJECT TO THE APPROVAL OF THE CITY ENGINEER PRIOR TO THE START OF WORK.
7. ALL EXISTING UTILITIES AND PRIVATE IMPROVEMENTS THAT BECOME DAMAGED DURING CONSTRUCTION SHALL BE COMPLETELY RESTORED TO THE SATISFACTION OF THE CITY INSPECTOR, AT CONTRACTOR'S SOLE EXPENSE.
8. SAFETY MEASURES: AT ALL TIMES THE CONTRACTOR SHALL BE SOLELY AND COMPLETELY RESPONSIBLE FOR CONDITIONS OF THE JOB SITE INCLUDING SAFETY OF PERSONS AND PROPERTY, (THIS REQUIREMENT SHALL APPLY CONTINUOUSLY AND NOT JUST DURING NORMAL WORKING HOURS) AND FOR ALL NECESSARY INDEPENDENT ENGINEERING REVIEWS OF THESE CONDITIONS. THE ENGINEER'S JOB SITE REVIEW IS NOT INTENDED TO INCLUDE REVIEW OF THE ADEQUACY OF THE CONTRACTOR'S SAFETY MEASURES.
9. THE CONTRACTOR SHALL PREPARE AND DISTRIBUTE A "GOOD NEIGHBOR LETTER" ADVISING EACH RESIDENCE 48 HOURS PRIOR TO BEGINNING THE WORK AT EACH LOCATION.
10. REFERENCE TO THE STATE STANDARD SPECIFICATIONS AND STANDARD PLANS MEANS THE 2025 EDITIONS.
11. CONTRACTOR SHALL REMOVE U.S.A. MARKINGS ONCE CONTRACT WORK IN EACH AREA IS COMPLETE.
12. BACKGROUND AERIAL PROVIDED ON THE PROJECT PLANS IS FOR INFORMATION PURPOSES ONLY.
13. HAUL ROUTE: (AS APPROVED BY THE CITY INSPECTOR).
14. WORK SHOWN ON PLANS FOR CURB AND GUTTER REMOVAL AND REPLACEMENT DO NOT REFLECT ACTUAL REMOVALS AND SHALL BE PER CITY'S REVIEW AND APPROVED LIMITS AFTER CONTRACTOR'S SURVEY.
15. TREES IDENTIFIED FOR ROOT INSPECTION BY CITY ARBORIST SHALL BE COORDINATED A MINIMUM OF 48 HOURS PRIOR TO CONCRETE REMOVAL. INSPECTION CAN NOT OCCUR UNTIL AFTER CONCRETE HAS BEEN REMOVED AND ROOTS 2" IN DIAMETER OR GREATER TO BE REMOVED/GRIND ARE MARKED WITH PAINT BY CONTRACTOR. ROOT PRUNING SHALL BE PERFORMED BY CONTRACTOR ACCORDING TO THE DIRECTION PROVIDED BY CITY ARBORIST.
16. SIDEWALK, CURB, AND GUTTER REMOVAL AND REPLACEMENT SHALL BE ACCORDING TO PLEASANTON STANDARD PLAN 101 (SEPARATED) OR 102 (MONOLITHIC).
17. DRIVEWAY REMOVAL AND REPLACEMENT SHALL BE ACCORDING TO PLEASANTON STANDARD PLAN 107.
18. REINFORCED CONCRETE PATHWAY REMOVAL AND REPLACEMENT SHALL BE ACCORDING TO DETAIL ON SHEET A5-1.
19. PORTLAND CEMENT CONCRETE MIX DESIGN SHALL BE ACCORDING TO PLEASANTON STANDARD SPECIFICATION SECTION 15.

\\delucchi\pww\Engineering\Streets\Miscellaneous Sidewalk and Pathway Replacement\CIP-26511\Drawings\CAD\CIP-26511_GENERAL.dwg 12-27-26 12:27pm srnguyen

REV	DATE	DESCRIPTION

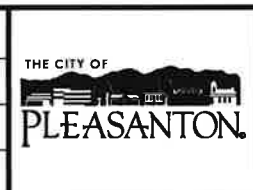

CITY OF PLEASANTON
PUBLIC WORKS DEPARTMENT

 **MICHAEL A. STELLA**
CITY ENGINEER
NO. 54642

2026 MISCELLANEOUS SIDEWALK AND PATHWAY REPLACEMENT

GENERAL NOTES

DESIGN:	BC	SCALE:	AS SHOWN	DRAWING NO.
DRAWN:	SN	PROJECT NO.:	CIP-26511	G-2
CHECKED:	BC	DATE:	APRIL 20, 2026	2 OF 8
TRAFFIC ENGINEER:	MT			

Pollution Prevention - It's Part of the Plan

Make sure your crews and subs do the job right!

Runoff from streets and other paved areas are a major source of pollution in San Francisco Bay. Construction activities can directly affect the health of the Bay unless contractors and crews plan ahead to keep dirt, debris, and other construction waste away from storm drains and local creeks. Following these guidelines will ensure your compliance with the City of Pleasanton requirements. Contact the City of Pleasanton, Department of Engineering at (925) 931-5650, or for private onsite work, please contact the Building and Safety Division at (925) 931-5300.

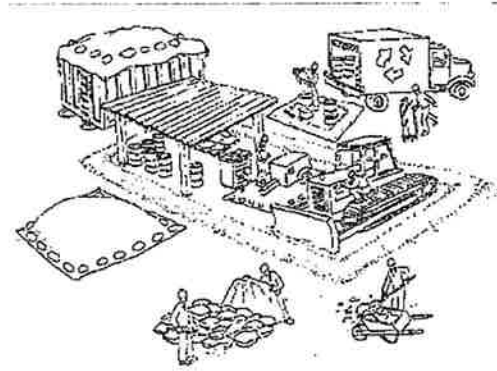

Materials storage & spill cleanup Non-hazardous materials management

- Sand, dirt, and similar materials must be stored at least 10 feet from catch basins, and covered with a tarp during wet weather or when rain is forecast.
- Use (but don't overuse) reclaimed water for dust control as needed.
- Sweep or vacuum streets and other paved areas daily. Do not wash down streets or work areas with water!
- Recycle all asphalt, concrete, and aggregate base material from demolition activities.
- Comply with City Ordinance for recycling construction materials, wood, gyp board, pipe, etc.
- Contact Pleasanton Garbage Service at 925-846-2042 for both recycling and debris disposal.
- Check dumpsters regularly for leaks and to make sure they don't overflow. Repair or replace leaking dumpsters promptly.

Hazardous materials management

- Label all hazardous materials and hazardous wastes (such as pesticides, paints, thinners, solvents, fuel, oil, and antifreeze) in accordance with city, state, and federal regulations.
- Store hazardous materials and wastes in secondary containment and cover them during wet weather.
- Follow manufacturer's application instructions for hazardous materials and be careful not to use more than necessary. Do not apply chemicals outdoors when rain is forecast within 24 hours.
- Be sure to arrange for appropriate disposal of all hazardous wastes.

Spill prevention and control

- Keep a stockpile of spill cleanup materials (rags, absorbents, etc.) available at the construction site at all times.
- When spills or leaks occur, contain them immediately and be particularly careful to prevent leaks and spills from reaching the gutter, street, or storm drain. Never wash spilled material into a gutter, street, storm drain, or creek!
- Report any hazardous materials spills immediately! Dial 911 or the Livermore/Pleasanton Fire Department at 925-454-2330.

Vehicle and equipment maintenance & cleaning

- Inspect vehicles and equipment for leaks frequently. Use drip pans to catch leaks until repairs are made; repair leaks promptly.
- Fuel and maintain vehicles on site only in a bermed area or over a drip pan that is big enough to prevent runoff.
- If you must clean vehicles or equipment on site, clean with water only in a bermed area that will not allow rinse water to run into gutters, streets, storm drains, or creeks.
- Do not clean vehicles or equipment on-site using soaps, solvents, degreasers, steam cleaning equipment, etc.



Earthwork & contaminated soils

- Keep excavated soil on the site where it is least likely to collect in the street. Transfer to dump trucks should take place on the site, not in the street.
- Use fiber rolls, silt fences, or other control measures to minimize the flow of silt off the site. See the approved erosion control plan for this site.



- Earth moving activities are only allowed during dry weather by permit and as approved by the City Inspector in the Field.
- Mature vegetation is the best form of erosion control. Minimize disturbance to existing vegetation whenever possible.
- If you disturb a slope during construction, prevent erosion by securing the soil with erosion control fabric, or seed with fast-growing grasses as soon as possible. Place fiber rolls down-slope until soil is secure.

- If you suspect contamination (from site history, discoloration, odor, texture, abandoned underground tanks or pipes, or buried debris), call Pleasanton/Livermore Fire Department at 925-454-2330 or the Regional Water Quality Control Board for help in determining what should be done, and manage disposal of contaminated soil according to their instructions.

Dewatering operations

- Reuse water for dust control, irrigation, or another on-site purpose to the greatest extent possible.
- Be sure to call Pleasanton's storm drain source control Inspector, Brian Lorimer, before discharging water to a street, gutter, or storm drain (925-931-5511). Filtration or diversion through a basin, tank, or sediment trap may be required.
- In areas of known contamination, testing is required prior to reuse or discharge of groundwater. Consult with the city inspector to determine what testing is required and how to interpret results. Contaminated groundwater must be treated or hauled off-site for proper disposal.



Saw cutting

- Always completely cover or barricade storm drain inlets when saw cutting. Use filter fabric, catch basin inlet filters, or sand/gravel bags to keep slurry out of the storm drain system.
- Shovel, absorb, or vacuum saw-cut slurry and pick up all waste as soon as you are finished in one location or at the end of each work day (whichever is sooner!).
- If saw cut slurry enters a catch basin, clean it up immediately.



Paving/asphalt work

- Do not pave during wet weather or when rain is forecast.
- Always cover storm drain inlets and manholes when paving or applying seal coat, tack coat, slurry seal, or fog seal.
- Place drip pans or absorbent material under paving equipment when not in use.
- Protect gutters, ditches, and drainage courses with sand/gravel bags, or earthen berms.
- Do not sweep or wash down excess sand from sand sealing into gutters, storm drains, or creeks. Collect sand and return it to the stockpile, or dispose of it as trash.
- Do not use water to wash down fresh asphalt concrete pavement.

Concrete, grout, and mortar storage & waste disposal

- Be sure to store concrete, grout, and mortar under cover and away from drainage areas. These materials must never reach a storm drain.
- Wash out concrete equipment/trucks off-site or designate an on-site area for washing where water will flow onto dirt or into a temporary pit in a dirt area. Let the water seep into the soil and dispose of hardened concrete with trash.
- Divert water from washing exposed aggregate concrete to a dirt area where it will not run into a gutter, street, or storm drain.
- If a suitable dirt area is not available, collect the wash water and remove it for appropriate disposal off site.



Painting

- Never rinse paint brushes or materials in a gutter or street!
- Paint out excess water-based paint before rinsing brushes, rollers, or containers in a sink. If you can't use a sink, direct wash water to a dirt area and spade it in.
- Paint out excess oil-based paint before cleaning brushes in thinner.
- Filter paint thinners and solvents for reuse whenever possible. Dispose of oil-based paint sludge and unusable thinner as hazardous waste.



Storm drain polluters maybe liable for fines of \$10,000 or more per day!

Bay Area Stormwater Management
Agencies Association (BASMAA)
1-888-BAYWISE

For more detailed information:
Get a copy of the "Field Manual" -- (510) 622-2465 or
www.abag.ca.gov

\\delueth\pww\Engineering\Streets\Miscellaneous\Sidewalk and Pathway Replacement\CIP-26511_BMP-G3.dwg(4-24-26 12:08pm enguyen

REV	DATE	DESCRIPTION	THE CITY OF PLEASANTON			2026 MISCELLANEOUS SIDEWALK AND PATHWAY REPLACEMENT		DESIGN:	BC	SCALE	AS SHOWN	DRAWING NO.
			CITY OF PLEASANTON PUBLIC WORKS DEPARTMENT				POLLUTION PREVENTION PLANS		DRAWN:	SN	PROJECT NO.:	CIP-26511
								CHECKED:	BC	DATE:	APRIL 20, 2026	3 OF 8
								TRAFFIC ENGINEER:	MT			

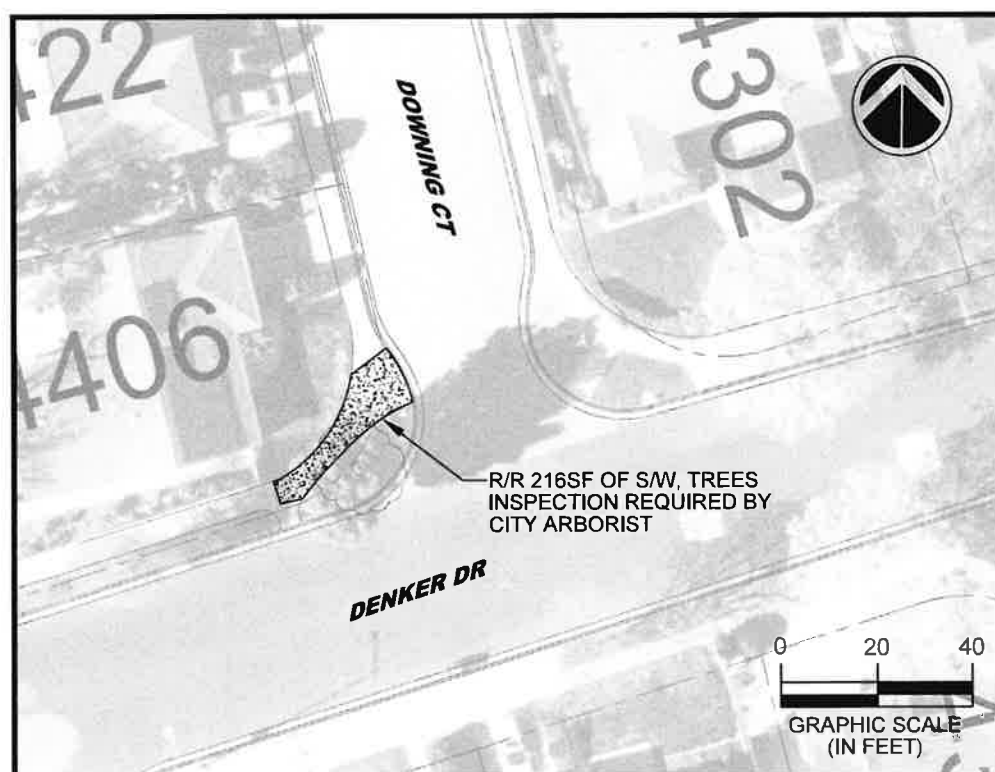

4406 DOWNING CT

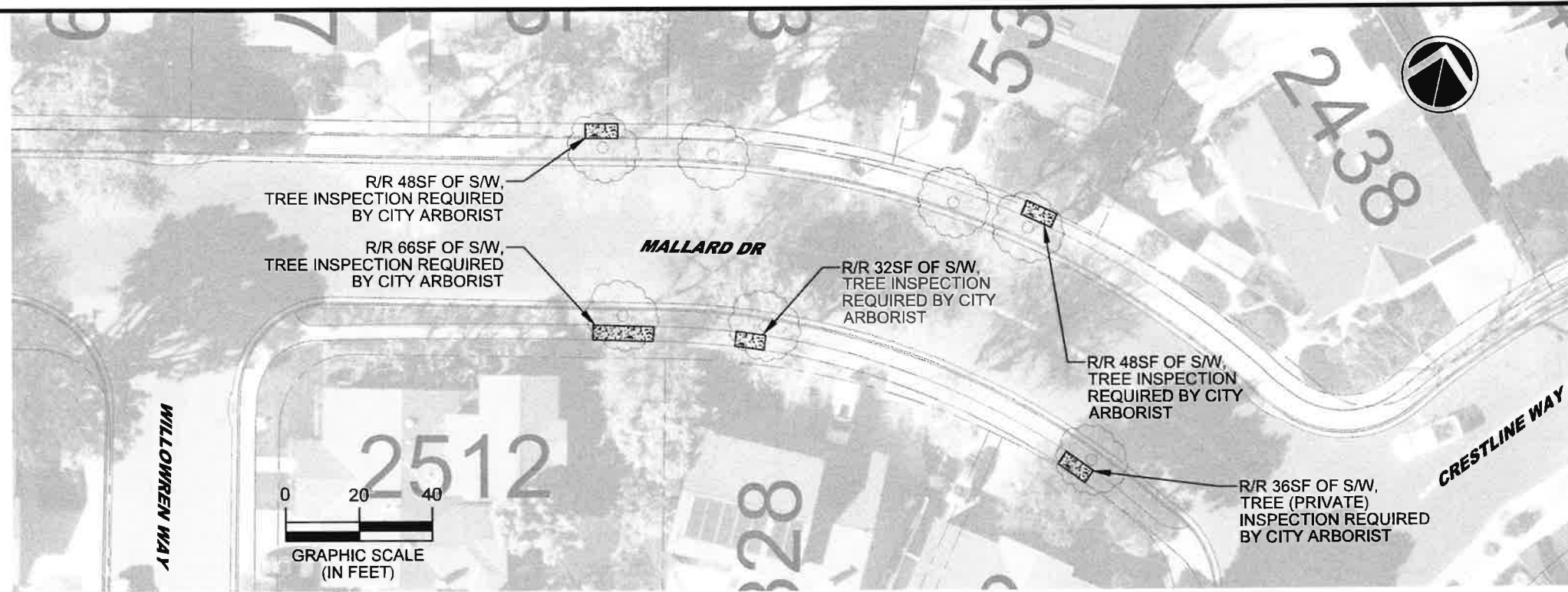

MALLARD DRIVE

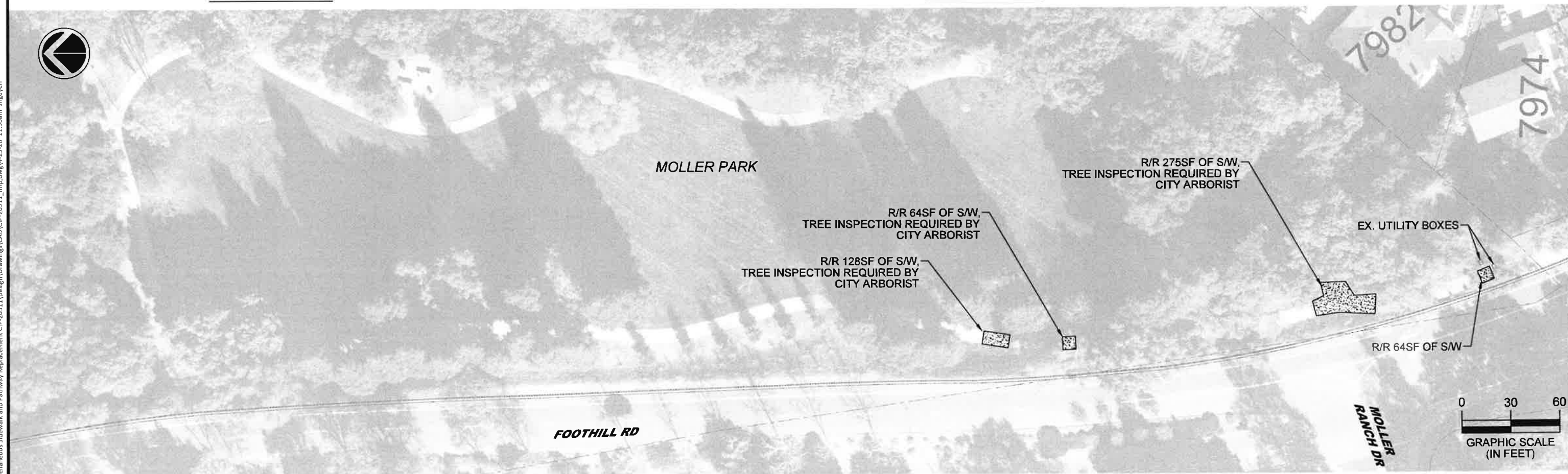

MOLLER PARK

\\delucchi\pwa\engineering\Streets\Miscellaneous Sidewalk and Pathway Replacement\CIP-26511\Design\Drawings\CAD\CIP-26511_imp.dwg 4/23/26 11:56am snguyen

REV.	DATE	DESCRIPTION

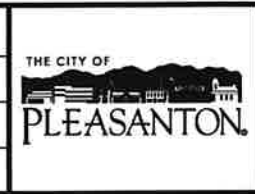

CITY OF PLEASANTON
PUBLIC WORKS DEPARTMENT



MICHAEL A. STELLA
CITY ENGINEER
NO. 54642

2026 MISCELLANEOUS SIDEWALK AND PATHWAY REPLACEMENT
DOWNING COURT, MALLARD DRIVE AND MOLLER PARK

DESIGN:	BC
DRAWN:	SN
CHECKED:	BC
TRAFFIC ENGINEER:	MT

SCALE:	AS SHOWN
PROJECT NO.:	CIP-26511
DATE:	APRIL 20, 2026

DRAWING NO.
A1-1
4 OF 8

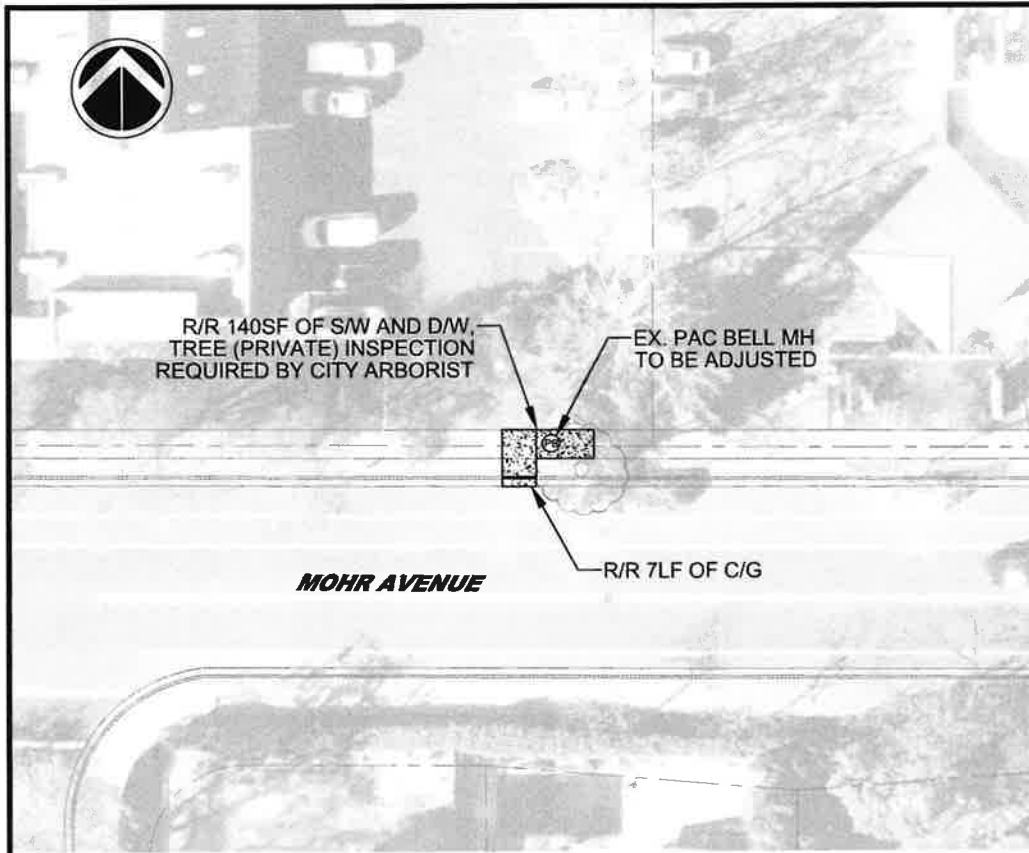

4125 MOHR AVENUE

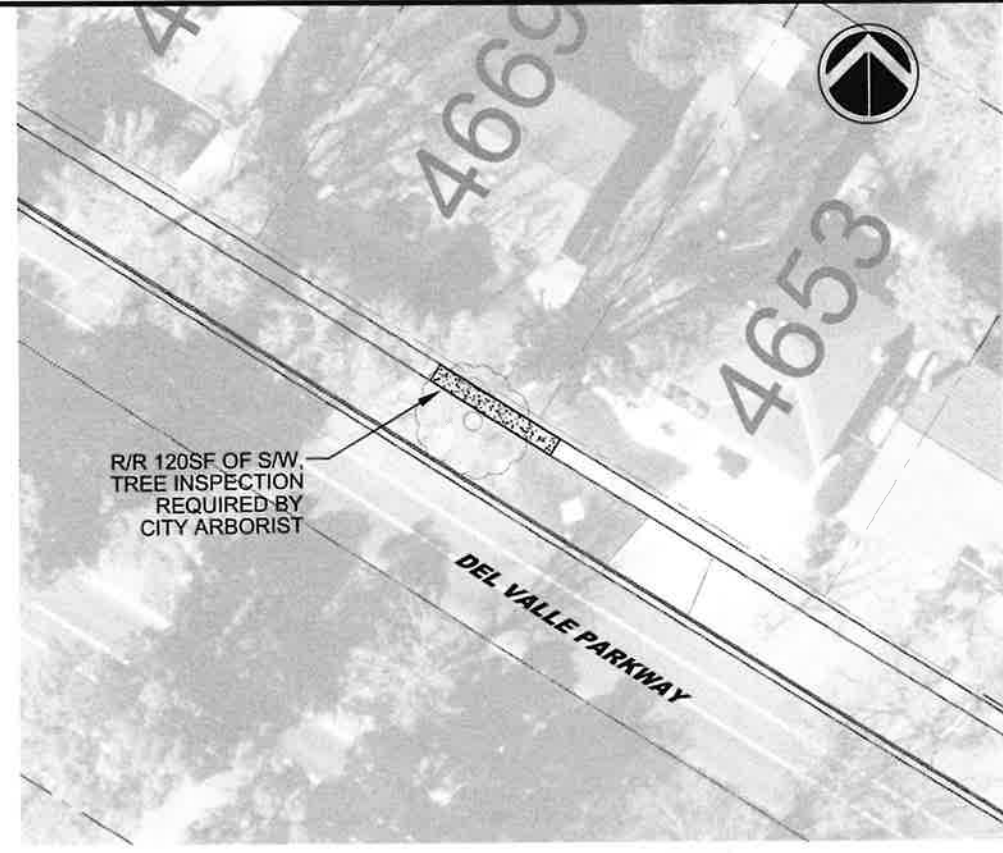

4653 DEL VALLE PARKWAY

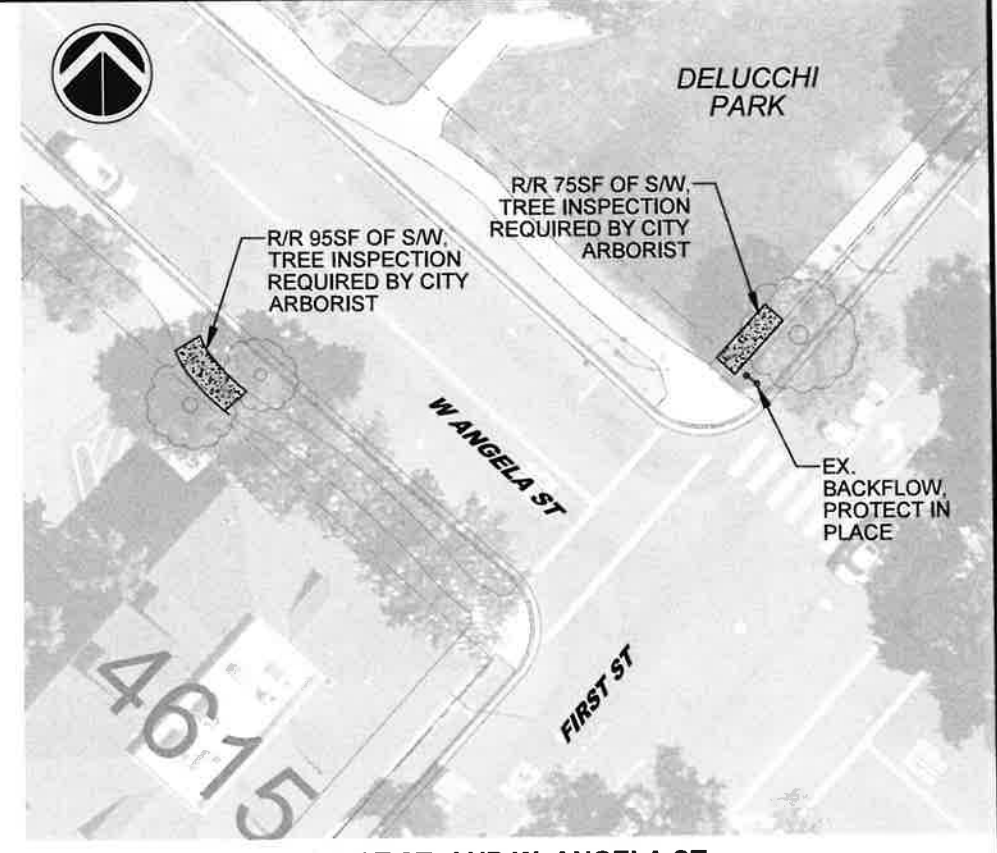

FIRST ST. AND W. ANGELA ST.

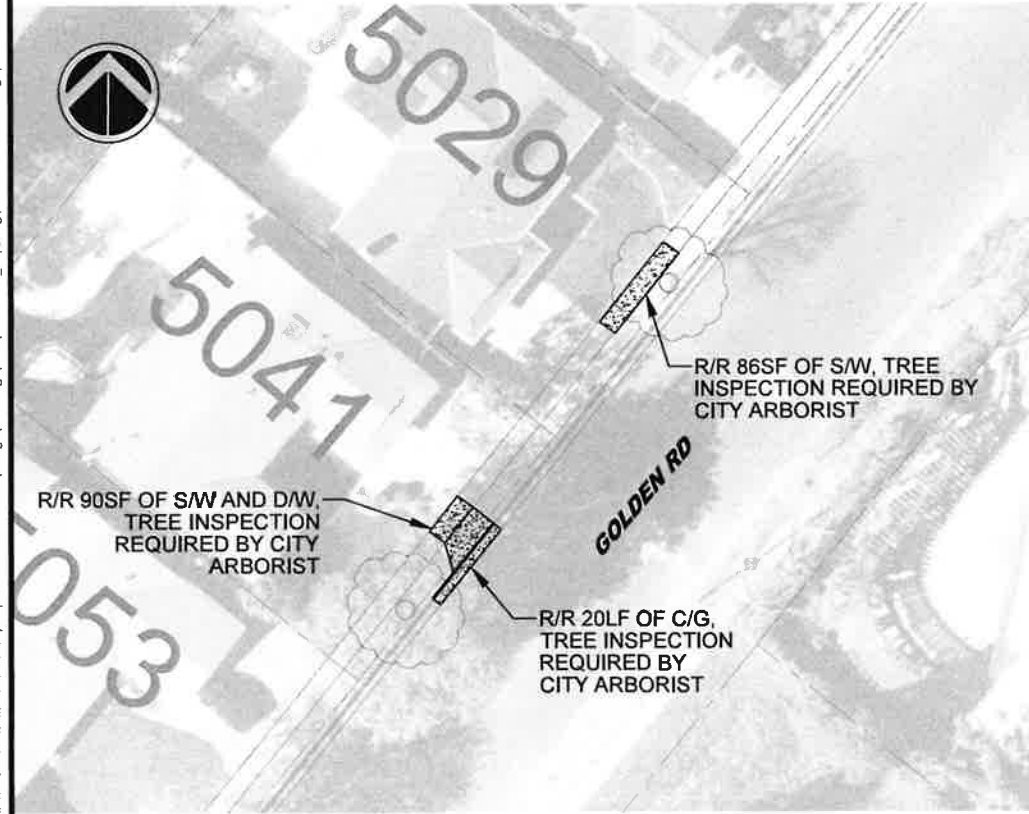

5029 AND 5041 GOLDEN RD

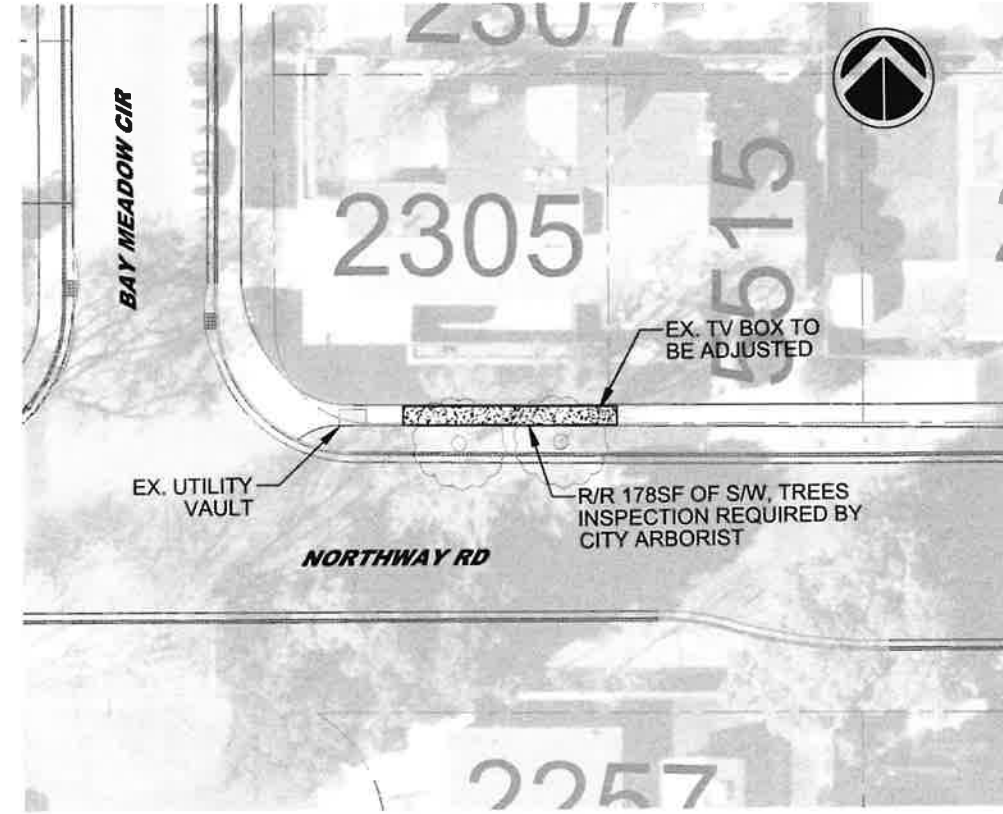

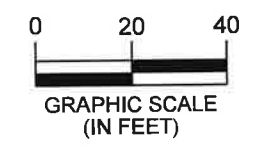

2305 BAY MEADOW CIR



\\delucchi\pwa\Engineering\Streets\Miscellaneous Sidewalk and Pathway Replacement\CIP-26511\Drawings\CAD\CIP-26511_imp.dwg M-23-26 11:54am snguyen

REV.	DATE	DESCRIPTION

CITY OF PLEASANTON
 PUBLIC WORKS DEPARTMENT

 MICHAEL A. STELLA
 CITY ENGINEER
 NO. 54642

2026 MISCELLANEOUS SIDEWALK AND PATHWAY REPLACEMENT
 BAY MEADOW CIR, GOLDEN RD, MOHR AVE. DEL VALLEY PARKWAY, FIRST ST. AND W. ANGELA ST.

DESIGN:	BC	SCALE:	AS SHOWN	DRAWING NO.
DRAWN:	SN	PROJECT NO.:	CIP-26511	
CHECKED:	BC	DATE:	APRIL 20, 2026	A2-1
TRAFFIC ENGINEER:	MT			5 OF 8

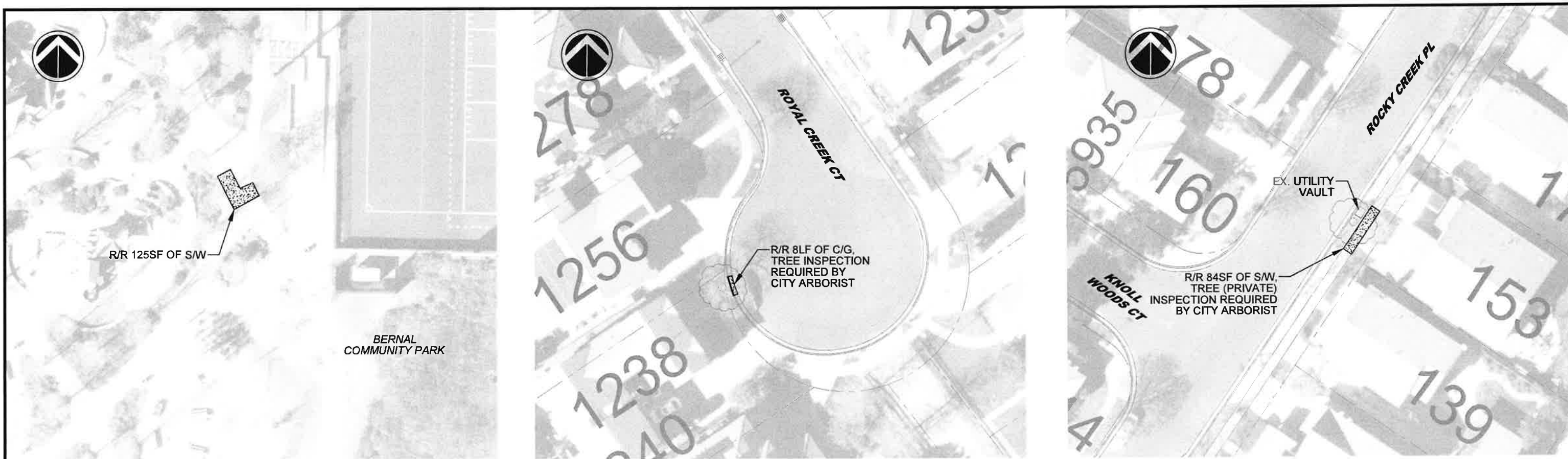

BERNAL COMMUNITY PARK

1238 ROYAL COURT

153 ROCKY CREEK PLACE

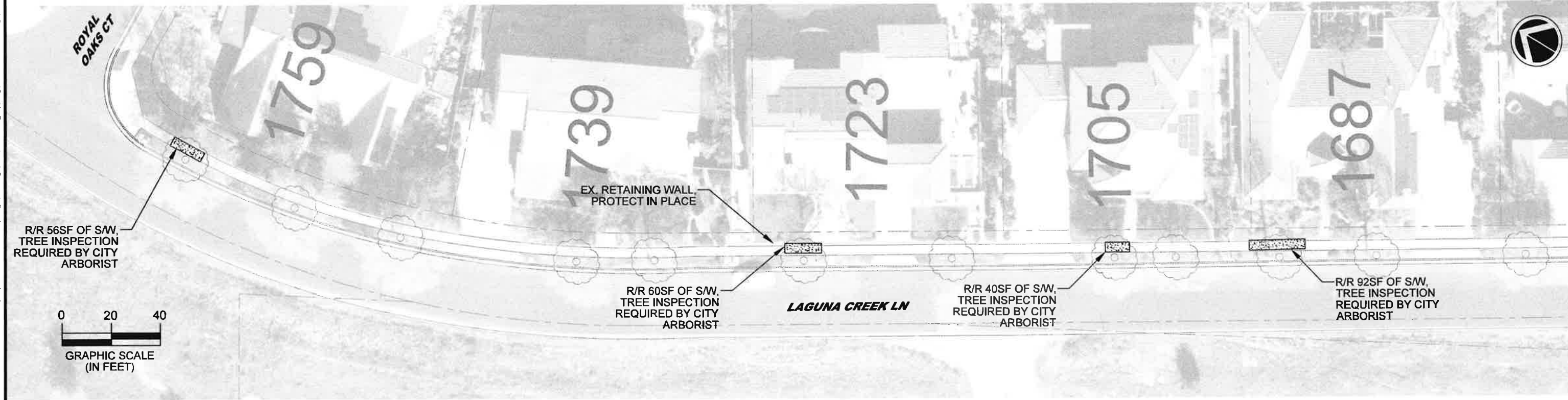

LAGUNA CREEK LANE

\\delucchi\pww\Engineering\Streets\Miscellaneous Sidewalk and Pathway Replacement\CIP-26511\Design\Drawings\CAD\CIP-26511_imp.dwg M-23-26 11:59am snguyen

REV.	DATE	DESCRIPTION



CITY OF PLEASANTON
PUBLIC WORKS DEPARTMENT

 MICHAEL A. STELLA
CITY ENGINEER
NO. 54642

2026 MISCELLANEOUS SIDEWALK AND PATHWAY REPLACEMENT
BERNAL COMMUNITY PARK, LAGUNA CREEK LANE, ROCKY CREEK PLACE, AND ROYAL COURT

DESIGN:	BC	SCALE:	AS SHOWN	DRAWING NO. A3-1 6 OF 8
DRAWN:	SN	PROJECT NO.:	CIP-26511	
CHECKED:	BC	DATE:	APRIL 20, 2026	
TRAFFIC ENGINEER:	MT			

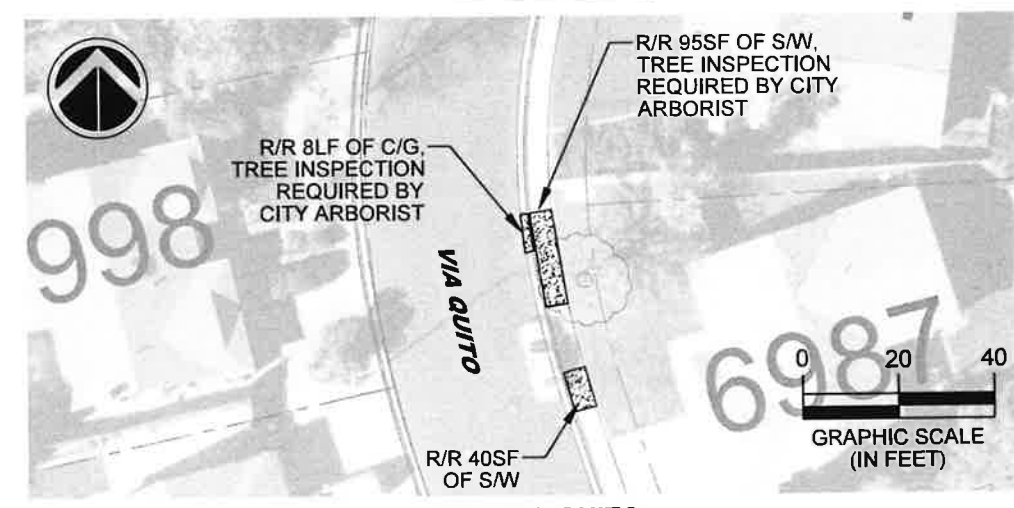
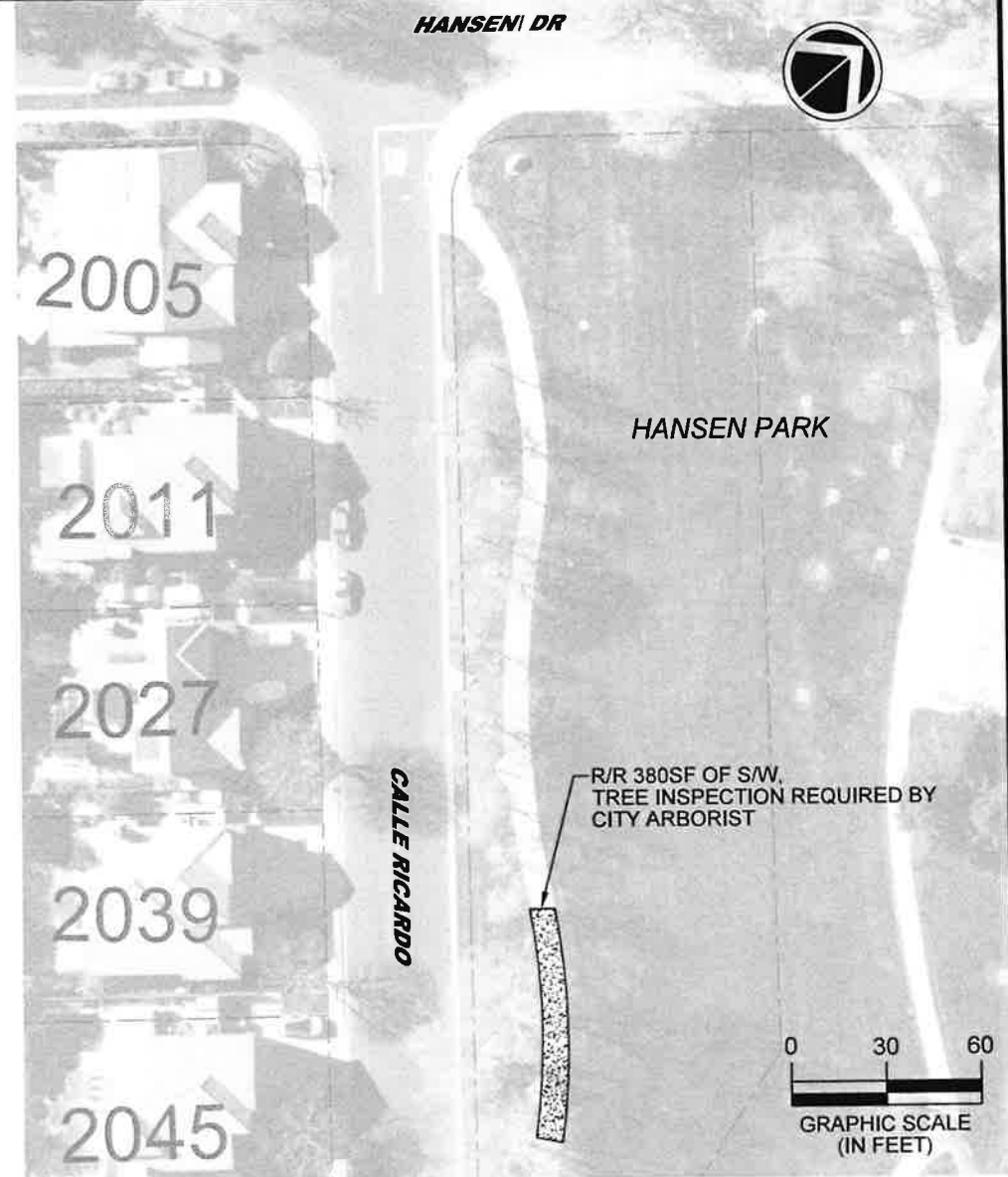
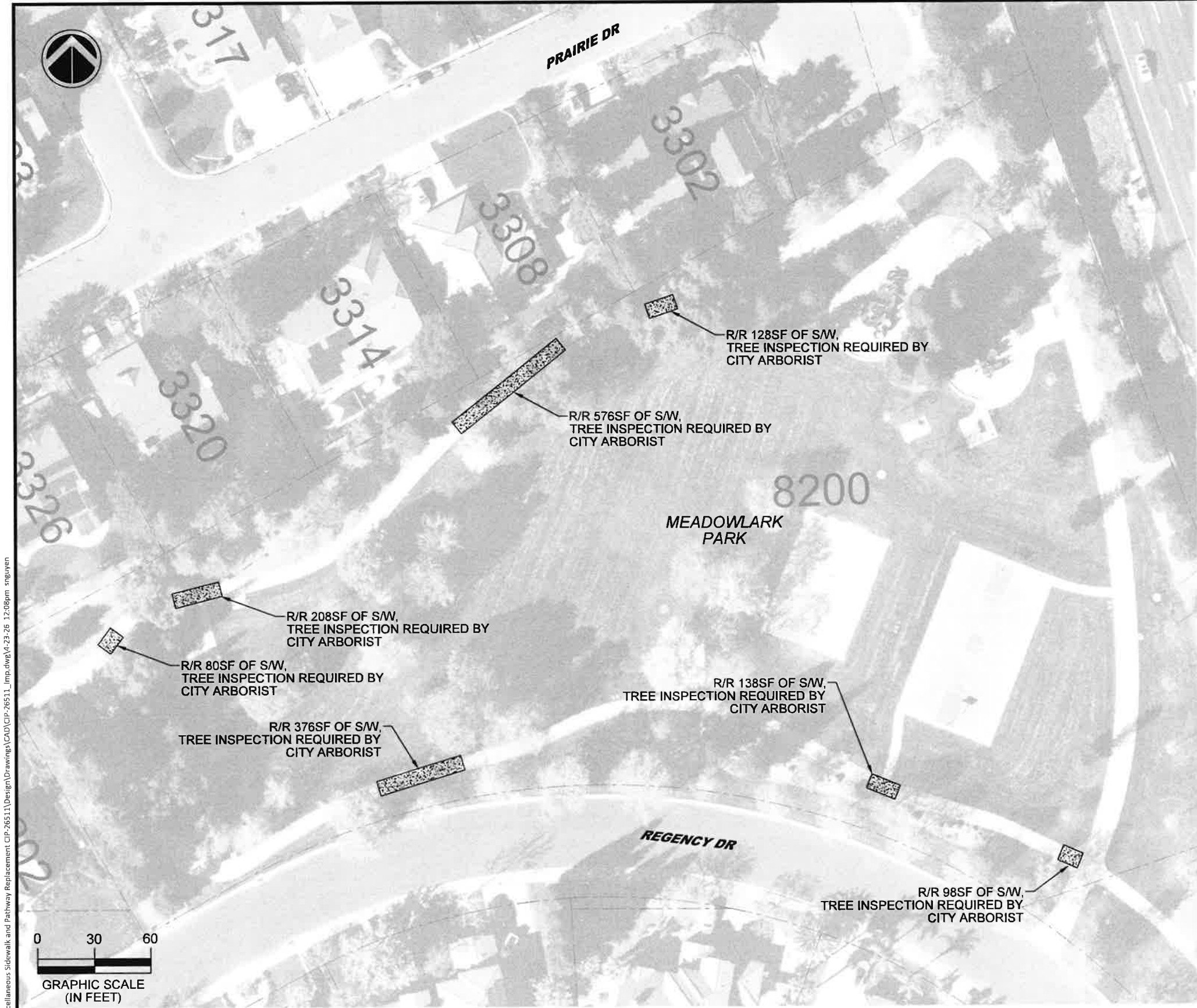

REV.	DATE	DESCRIPTION

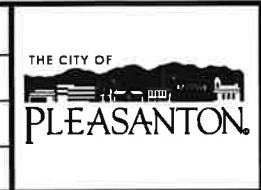

CITY OF PLEASANTON
PUBLIC WORKS DEPARTMENT

Michael A. Stella
MICHAEL A. STELLA
CITY ENGINEER
NO. 54642

2026 MISCELLANEOUS SIDEWALK AND PATHWAY REPLACEMENT
HANSEN PARK, MEADOWLARK PARK, AND VIA QUITO

DESIGN:	BC	SCALE:	AS SHOWN	DRAWING NO.	A4-1 7 OF 8
DRAWN:	SN	PROJECT NO.:	CIP-26511		
CHECKED:	BC	DATE:	APRIL 20, 2026		
TRAFFIC ENGINEER:	MT				

\\delucchi\pwa\Engineering\Streets\Miscellaneous Sidewalk and Pathway Replacement\CIP-26511\Drawings\CAD\CIP-26511_imp.dwg M-23-26 12:08pm snguyen

SPORKS PARK DR



R/R 494SF OF REINFORCED CONCRETE PATHWAY,
TREE INSPECTION REQUIRED BY CITY ARBORIST

R/R 100SF OF REINFORCED CONCRETE PATHWAY,
TREE INSPECTION REQUIRED BY CITY ARBORIST

R/R 670SF OF REINFORCED CONCRETE PATHWAY,
TREE INSPECTION REQUIRED BY CITY ARBORIST
(LOCATIONS MARKED OUT IN PARK)

R/R 605SF OF REINFORCED CONCRETE PATHWAY,
TREE INSPECTION REQUIRED BY CITY ARBORIST

R/R 360SF OF REINFORCED CONCRETE PATHWAY,
TREE INSPECTION REQUIRED BY CITY ARBORIST

DIRT ROAD ACCESS

KEN MERCER
SPORTS PARK

PARKSIDE DR
5700

← 650' (±) TO DRIVEWAY AT 3015 HOPYARD RD.

PLEASANTON CANAL

NOTES:

1. ALL CONCRETE PATHWAY REPLACEMENT WITHIN KEN MERCER SPORTS PARK SHALL BE REINFORCED WITH REBAR AND WITH 6-INCH CONCRETE OVER 6-INCH AGGREGATE BASE. SEE DETAIL ON THIS DRAWING.
2. SEE CITY STANDARD DETAIL 101 FOR DOWELING INTO EXISTING CONCRETE.

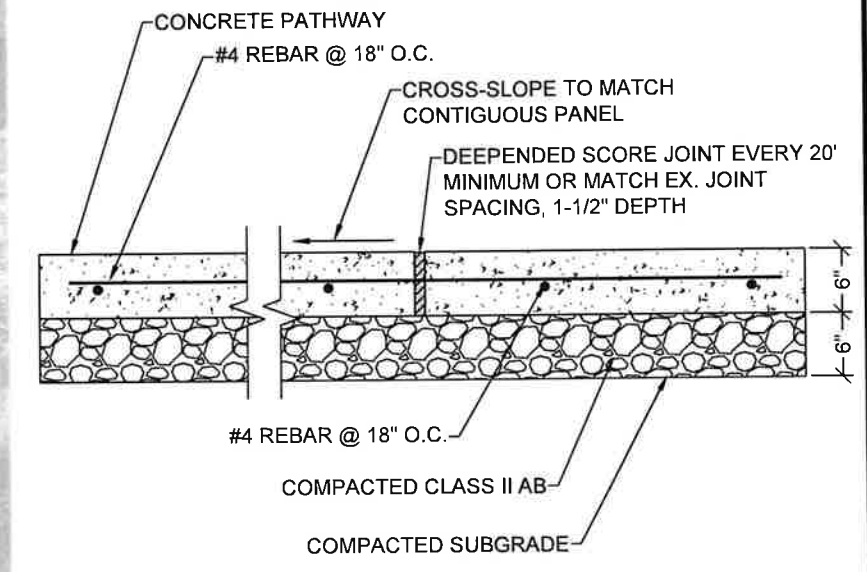

REINFORCED CONCRETE PATHWAY DETAIL
NOT TO SCALE

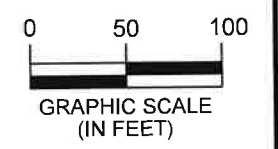

\\delucchi\pw\Engineering\Streets\Miscellaneous Sidewalk and Pathway Replacement CIP-26511\Drawings\CAD\CIP-26511_imp.dwg(4-24-26 01:48pm srnguyen

REV.	DATE	DESCRIPTION

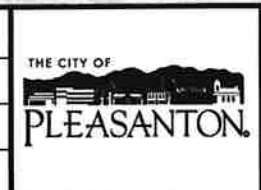

CITY OF PLEASANTON
PUBLIC WORKS DEPARTMENT



MICHAEL A. STELLA
CITY ENGINEER
NO. 54642

2026 MISCELLANEOUS SIDEWALK AND PATHWAY REPLACEMENT

KEN MERCER SPORTS PARK

DESIGN:	BC	SCALE:	AS SHOWN	DRAWING NO.:	A5-1
DRAWN:	SN	PROJECT NO.:	CIP-26511	8 OF 8	
CHECKED:	BC	DATE:	APRIL 20, 2026		
TRAFFIC ENGINEER:	MT				