

YOUR TAX DOLLARS AT WORK
FUNDED BY GAS TAX, SB-1, MEASURE B, BB, AND F

G=9/13/2019 (9:00 a.m. - 4:00 p.m.)
P= NIGHT WORK SUNDAY 9/22/2019 (8:00 p.m. - 6:30 a.m.)

G=9/11/2019 (8:00 a.m. - 5:00 p.m.)
P= NIGHT WORK 9/18/2019 & 9/19/2019 (7:00 p.m. - 7:00 a.m.)

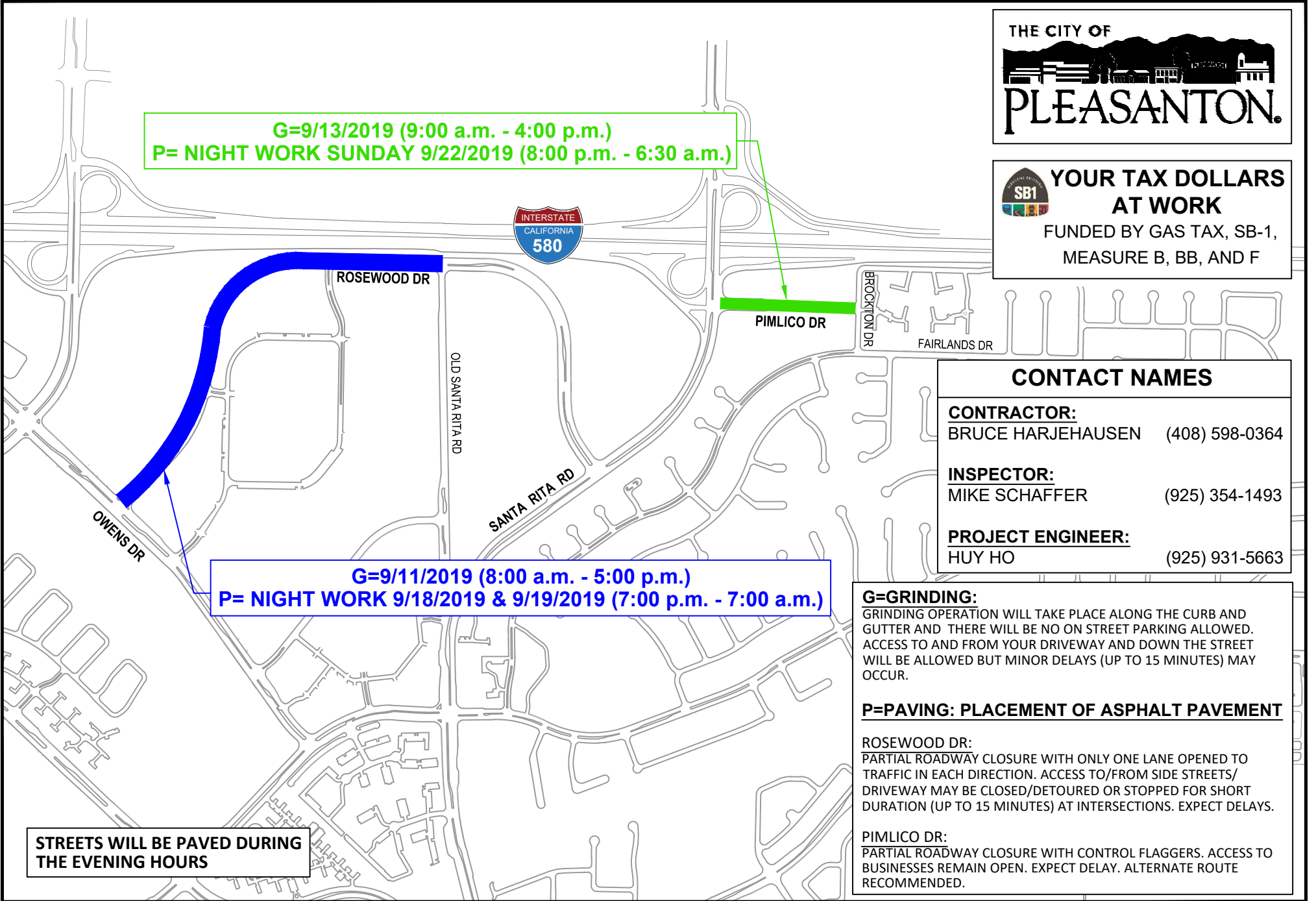

CONTACT NAMES	
CONTRACTOR:	
BRUCE HARJEHAUSEN	(408) 598-0364
INSPECTOR:	
MIKE SCHAFFER	(925) 354-1493
PROJECT ENGINEER:	
HUY HO	(925) 931-5663

G=GRINDING:
GRINDING OPERATION WILL TAKE PLACE ALONG THE CURB AND GUTTER AND THERE WILL BE NO ON STREET PARKING ALLOWED. ACCESS TO AND FROM YOUR DRIVEWAY AND DOWN THE STREET WILL BE ALLOWED BUT MINOR DELAYS (UP TO 15 MINUTES) MAY OCCUR.

P=PAVING: PLACEMENT OF ASPHALT PAVEMENT
ROSEWOOD DR:
PARTIAL ROADWAY CLOSURE WITH ONLY ONE LANE OPENED TO TRAFFIC IN EACH DIRECTION. ACCESS TO/FROM SIDE STREETS/ DRIVEWAY MAY BE CLOSED/DETOURED OR STOPPED FOR SHORT DURATION (UP TO 15 MINUTES) AT INTERSECTIONS. EXPECT DELAYS.

PIMLICO DR:
PARTIAL ROADWAY CLOSURE WITH CONTROL FLAGGERS. ACCESS TO BUSINESSES REMAIN OPEN. EXPECT DELAY. ALTERNATE ROUTE RECOMMENDED.

STREETS WILL BE PAVED DURING THE EVENING HOURS

FOR MORE INFORMATION, PLEASE VISIT THE CITY'S WEBSITE:
<http://www.cityofpleasantonca.gov/gov/depts/engineering/projects/roadwork.asp>
September 9, 2019

ANTICIPATED DATES SUBJECT TO CHANGE. PLEASE FOLLOW NO PARKING SIGNS PLACED 48 HOURS ADVANCE OF WORK.